

Keep Your Production Line Running with Confidence

Increase uptime and durability with Southworth Lift Tables

When lift tables are integrated into a production process, they are often subjected to more rigorous use than stand-alone lifts. In this environment, uptime is critical since taking a lift off line for unplanned maintenance means costly production interruptions.

Southworth production ready lifts are equipped with heavy duty features to ensure durability, reliability, and maximum uptime—and, with regular PM service, can extend the interval before major maintenance and replacement of renewable parts is required up to 200,000 cycles or more.

Production Ready Features:

- Oversized Cylinder Rods
- High Strength Alloy Shafts and Pins
- Thicker Composite Bushings for Added Strength and Durability
- Regreasable Needle Bearing Cam Followers
- Reinforced Roller Tracks with Wear Strips Added
- Available on LS, LSH, and DL Series Lifts and Many Other Models
- Extends the Mean Time Between Repairs
- Ideal for Lifts in Areas Where Access for Maintenance is Limited



Oversized center pivot shaft, retained composite self-lubricating bushings



Soft connectivity for electrical connections

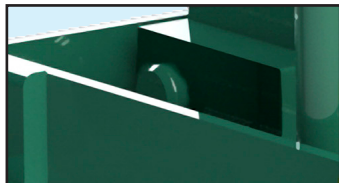

Oversized hinge pins, retained composite self-lubricating bushings

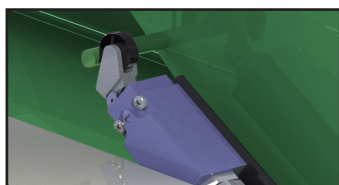

Upper limit switch

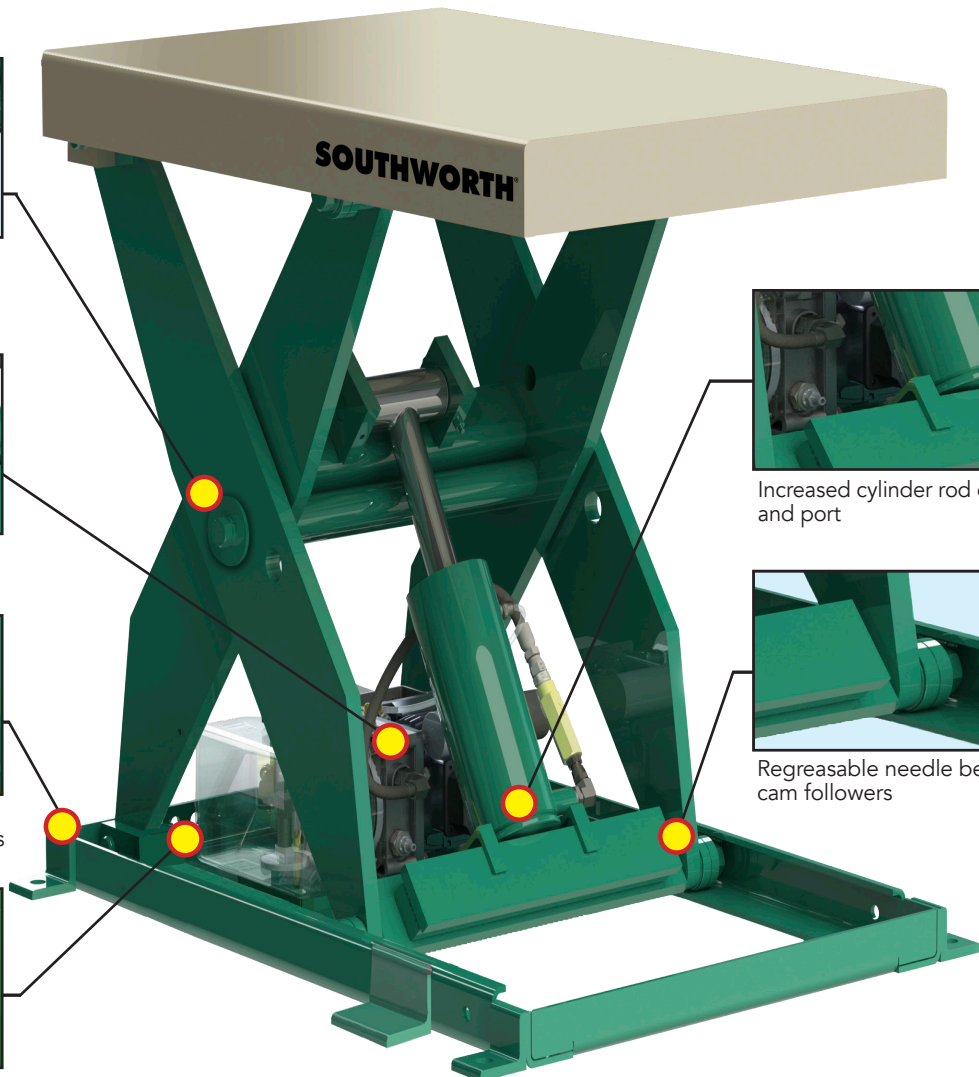

Increased cylinder rod diameter and port

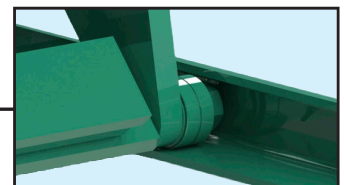

Regreasable needle bearing cam followers

SOUTHWORTH®

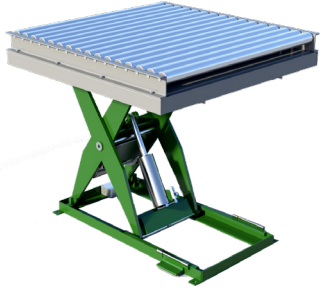

Ideally suited to meet the challenge of handling dynamic and non-uniform loads.

Specify a Production Ready Lift if your application involves any of the following:

- Loads moving across the platform (conveyor tops, ball transfers, turntables)
- Non-uniform loads that consistently place more weight on one end or side
- Where lifts travel while loaded such as on AGVs or towed carts

What's included in Production Ready Lift Tables

Lift Table Component	Standard Lift	Production Ready Lift
Center pivot pin / bushings and retention	Stress proof pin/DU style bushings and welded washers	Turned, ground and polished high-strength alloy shafting with a glass filament-wound PTFE impregnated epoxy backed bushing. Shaft locked and fitted with snap rings.
Cylinder clevis pin / bushings and retention	Stress proof pin/DU style bushings and keepers	Turned, ground and polished high-strength alloy shafting with a glass filament-wound PTFE impregnated epoxy backed bushing. Shaft locked and fitted with keepers.
Upper and lower hinge pins / bushings and retention	Stress proof pin/DU style bushings and cotter pins	Turned, ground and polished high-strength alloy shafting with a glass filament-wound PTFE impregnated epoxy backed bushing. Shaft locked and fitted with keepers.
Rollers and bushings	Steel with DU style bushings and cotter pins	Regreasable needle bearing style, hardened cam followers.
Roller wear strips	None	Welded cold rolled steel
Cylinder rod (typical)	Standard 1-1/2" (typical)	Standard 1-3/4" (typical)
Cylinder port	Standard #6 SAE	Oversized #8 SAE
Upper limit switch	None	Standard
Expected cycle count before maintenance*	50,000	200,000 per year

*One cycle is generally considered one full up and down with no jogs and a uniform load at 80% of rated lift capacity.



SOUTHWORTH®

Southworth Products Corp
P.O. Box 1380, Portland, ME 04104-1380
TEL: (800) 743-1000 • (207) 878-0700
Email: info@SouthworthProducts.com